

# SAMPLING GUIDE

## Hop Latent Viroid & Root Pathogen



### Sampling Instructions

- For each cultivar you wish to test, sterilize a pair of scissors by soaking in 10% bleach solution for 10 minutes and wipe dry with fresh paper towel. Spray gloved hands with 10% bleach and spread evenly.
- Using scissors, remove a small section of lateral roots from 3-4 different locations. Lateral roots can be accessed by pulling the pot/vessel away from soil/media near the top of the vessel. Each piece of root must be less than 1/4" with up to a maximum 1" of root length total in each sample.
- Open the Sample Tube, add the sample, and close the tube tightly to inactivate the sample. Submerge the chopped sample in the solution by inverting the tube 5-10 times to coat all plant material in the buffer.

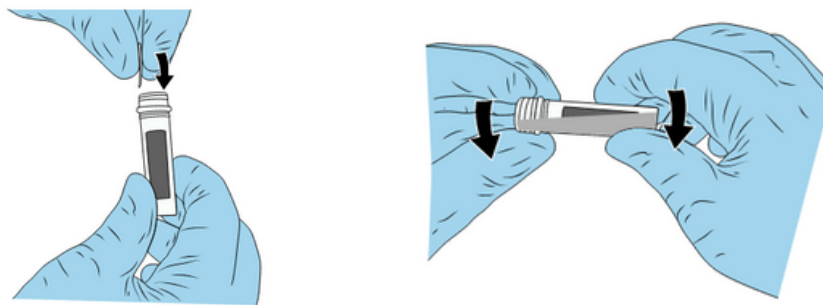
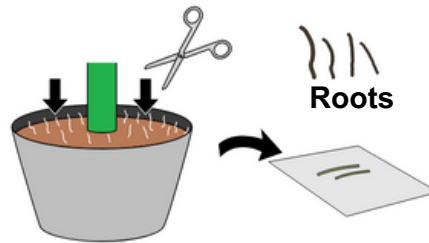

- Immediately place the sample into a cooler with ice or directly into a refrigerator.

Store the sample in the refrigerator overnight and then ship the samples and a fully completed COC form immediately. The fillable version is available on our website [www.newagelaboratories.com](http://www.newagelaboratories.com).

Science You Can Use, Partners You Can Trust

160 Veterans Blvd, South Haven, MI 49090

(269) 637-5658

(888)-685-1628