

SAMPLING GUIDE

Hop Latent Viroid & Root Pathogen



Sampling Instructions

- For each cultivar you wish to test, sterilize a pair of scissors by soaking in 10% bleach solution for 10 minutes and wipe dry with fresh paper towel. Spray gloved hands with 10% bleach and spread evenly.
- Using scissors, remove a small section of lateral roots from 3-4 different locations. Lateral roots can be accessed by pulling the pot/vessel away from soil/media near the top of the vessel. Each piece of root must be less than 1/4" with up to a maximum 1" of root length total in each sample.
- Open the Sample Tube, add the sample, and close the tube tightly to inactivate the sample. Submerge the chopped sample in the solution by inverting the tube 5-10 times to coat all plant material in the buffer.

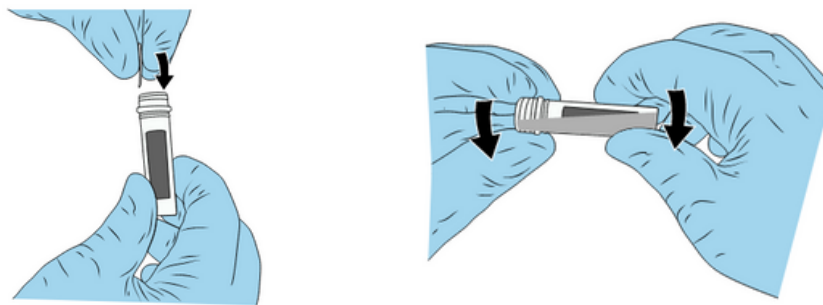
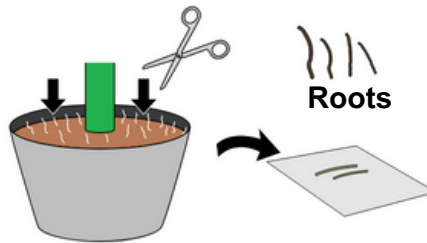

- Immediately place the sample into a cooler with ice or directly into a refrigerator.

Store the sample in the refrigerator overnight and then ship the samples and a fully completed COC form immediately. The fillable version is available on our website www.newagelaboratories.com.

Science You Can Use, Partners You Can Trust

160 Veterans Blvd, South Haven, MI 49090

(269) 637-5658

(888)-685-1628